



पुर्णा International School

Shree Swaminarayan Gurukul, Zundal

SUMMATIVE ASSIGNMENT – 2 [2021-22]

Grade – 4

Sub- COMPUTER

Syllabus – CH- 6 , 7 , 8 , 9

(From Textbook)

A) Choose the correct options in the following questions: -

- Which of the following is the first thing you would do to make changes to a picture?
 - Delete the picture
 - Copy the picture
 - Select the picture**
 - Paste the picture
- Which option will you use to remove part of a picture?
 - Paste
 - Copy
 - Select all
 - Crop**
- Which of the following options will make a picture appear slanted?
 - Crop
 - Skew**
 - Rotate
 - Resize
- In which group are the copy and cut options present?
 - Image
 - Clipboard**
 - Tool
 - Shapes
- Which option helps you to make copies of a picture?
 - Resize
 - Skew
 - Copy**
 - Cut
- You can use the _____ selection option to select an irregular part of a picture.
 - paint
 - free-form**
 - picture
 - rectangular
- Paint has _____ tools you can use to make changes to a picture.
 - one
 - many**
 - two
 - none
- The internet is a global network of-
 - phones
 - computers
 - TVs
 - all of these**
- WWW stands for
 - World Wide Wild
 - World Wide Web**
 - World Wide Weather
 - World Wide World
- Which of the following is not a web browser?
 - Internet Explorer
 - Google Chrome
 - Opera
 - Gmail**
- All the web pages have an address known as
 - web address
 - URL
 - web pages
 - both a and b**

12. You can use the internet to send and receive
a) messages b) files c) images **d) all of these**
13. A collection of connected computer networks is spread all over the world. It is called the _____.
a) Internet b) Google c) chrome d) none of these
14. The first page of a website is called the _____ .
a) hyperlink **b) homepage** c) collection d) all of these
15. This command is used to make the turtle stop drawing a line.
a) PD **b) PU** c) ST d) HT
16. This command is used to make the turtle draw line again.
a) PD b) PU c) ST d) HT
17. The HIDE TURTLE command is written in short as
a) HDT b) PU c) ST **d) HT**
18. What does the PE command do?
a) It erases a line b) It draws a line
c) It hides the turtle d) It stops drawing a line
19. Which command is used to show the turtle again?
a) PD b) PU **c) ST** d) HT
20. The turtle draws a line as it moves on the _____ .
a) Screen b) picture c) movies d) none
21. As the Logo turtle moves, it draws a
a) Line b) Cylinder c) Circle d) All of these
22. A place where two lines meet is called a
a) Side b) Triangle **c) Corner** d) None of these
23. Which of the following has four equal sides and four corners?
a) Square b) Rectangle c) Triangle d) Pentagon
24. Which of the following has three sides and three corners?
a) Square b) Rectangle **c) Triangle** d) Pentagon
25. Which of the following has five sides and five corners?
a) Square b) Rectangle c) Triangle **d) Pentagon**

B) Fill in the blanks: -

1. Use the **select** tool to select a part of the picture that you want to change.
2. To select an irregular part of the picture, click on **free-form** selection.
3. To open the Resize and Skew dialog box, press CTRL + **W**.

4. Use the **Rotate** option to flip a picture or a part of it.
5. Use the **paste-form** option to paste an existing picture into Paint.
6. The World Wide Web is popularly known as the **web** .
7. A type of software used to view the contents of web pages is known as a **web browser** .
8. A highlighted word or image on a web page is called a **hyperlink**.
9. The first page of a website is called the **home** page.
10. A **search** engine has a search box.
11. The short form of the PENUP command is **PU** .
12. The short form of the PENDOWN commands is **PD** .
13. The PU command is used to make the turtle **stop** drawing a line.
14. The **PE** command is used to make the turtle erase a line.
15. Use the **PPT** command to undo the PE command.

C) Write T for true or F for false:-

1. You can crop a picture, delete it, resize it or copy it. **T**
2. Free-form selection is used to select an irregular part of a picture. **F**
3. The delete option removes the selected part of a picture. **F**
4. The part of a picture you want to keep is removes after applying the crop option. **T**
5. A collection of connected computer network is called **Wi-Fi**. **F**
6. E-mail is the short form of electronic mail. **T**
7. The Web browser is a huge collection of useful resources. **F**
8. The address of a web page is called URL. **T**
9. The crab draws a line as it moves on a screen. **F**
10. The **SHOWTURTLE** command is return as **HT** in short. **F**
11. To make the turtle erase a line we use the **PENERASE** command. **T**
12. A square has four equal sides and four corners. **T**
13. A place where three lines meet is called a corner. **F**
14. A plane figure that has three sides and three corners is called triangle. **T**
15. As the logo turtle moves, it draws a rectangle. **F**

D) Match the following:-

1. PowerPoint	a. Resize and skew	2
2. CTRL + W	b. Web browser	4
3. MS Paint	c. Collection of linked web pages	5
4. Mozilla Firefox	d. Outline tab	10
5. Website	e. To show the turtle again	6
6. The ST command	f. Slide show	1
7. WWW	g. five sides and five corner	9
8. HT	h. Image group	3
9. Pentagon	i. WORLD WIDE WEB	7
10. Rotate	j. HIDE TURTLE	8
11. Cropping a picture	k. PENDOWN COMMAND	13
12. URL	l. Moving from one web site to another	14
13. PD	m. Invented World Wide Web in 1989	15
14. Net surfing	n. Uniform Resource Locator	12
15. Tim Berners-Lee	o. Removing the unnecessary part	11

E) Write down the word meaning:-

1. Crop: - **an option that lets you delete part of a picture.**
2. Skew: - **an option that makes a selected picture appear slanted.**
3. World Wide Web: - **a collection of web pages that contain text, pictures, audio and videos.**
4. Web browser: - **a type of software needed to view the contents of web pages.**
5. URL: - **the address of a web page .**
6. Hyperlink: - **a highlighted word or image that takes you to a new web page when you click on it.**
7. E-mail: - **messages that are sent and received through the internet .**
8. Square: - **a plane figure that has four equal sides and four corners.**
9. Rectangle: - **a plane figure that has four sides with opposite sides equal and four corners.**
10. Triangle: - **a plane figure that has three sides and three corners.**

11. Pentagon: - **a plane figure that has five sides and five corners.**

12. Hexagon: - **a plane figure that has six sides and six corners.**

F) Write a short answers:-

Q1) On which tab is the image group found?

Ans- **Home Tab**

Q2) Which selection help to select a square or rectangular part of a picture?

Ans- **Rectangular selection.**

Q3) Which option helps to move a picture from one place to another?

Ans- **Copy.**

Q4) In Home tab which options is used to make a picture smaller or larger?

Ans- **Resize option**

Q5) Which button helps to rotate or flip a picture?

Ans- **Rotate button**

Q6) What is the Internet?

Ans: - **A collection of connected networks is spread all over the world is called Internet.**

Q7) Define a web page?

Ans: - **A web page is a single page on the internet.**

Q8) What do u mean by a hyperlink?

Ans: - **A hyperlink means a highlighted word.**

Q9) What is a website?

Ans: - **A collection of linked web pages is called a website.**

Q10) Name any two search engines?

Ans: - **1) Google 2) yahoo**

Q11) What is Google Chrome?

Ans: - **Google Chrome is a search engine.**

Q12) What is the full form of URL?

Ans: - **Uniform Resource Locator.**

Q13) What does the word internet stand for?

Ans: - **The word internet stands for interconnected network.**

Q14) What command will you give to undo the PU command?

Ans. **PENDOWN command will we give to undo the PU command.**

Q15. What is the short form of the HIDETURTLE command?

Ans. **HT is the short form of the HIDETURTLE command.**

Q16. Which command is used to erase a line?

Ans. PE command is used to erase a line.

Q17. What do you mean by corner?

Ans. A place where two lines meet is called corner .

Q18. How many sides or corner in a pentagon figure?

Ans. 5 sides and 5 corners.

Q19. What is hexagon and draw its logo?

Ans. A plane figure that has six sides and six corners are hexagon.



Q 20. When the logo turtle moves, what does it draw?

Ans. The logo turtle moves, it draw a line.

G) Write the uses of command MSWLogo: -

<u>COMMAND</u>	<u>USES</u>
PENUP	To make the turtle stop drawing a line.
PENDOWN	To undo the PU command
HIDETURTLE	To hide the turtle
SHOWTURTLE	To show the turtle again
PEN ERASE	To make the turtle erase a line
PEN PAINT	To undo the PE command

H) Label the parts of the given screen: -

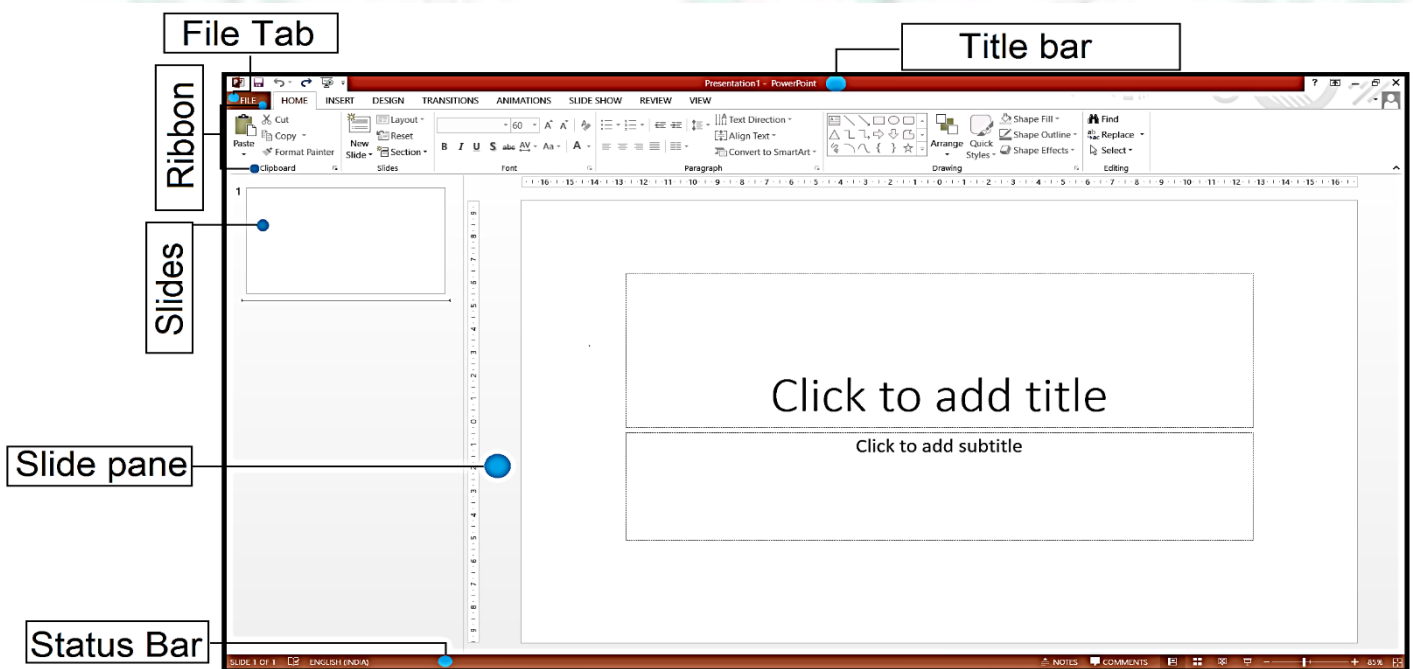

I) Write the names of the Browsers or Search engines given below:-

GOOGLE	INTERNET EXPLORER	GOOGLE CHROME	Ask
Bing	YAHOO	MOZZILLA FIREBOX	OPERA

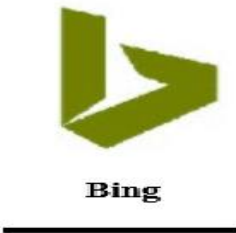

J) What shapes do you get with the following commands? Draw them in the boxes below and write their name:-

1) REPEAT 4 [FD 40 RT 90]

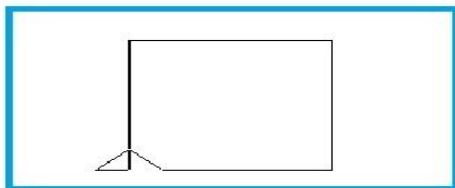

SQUARE

2) REPEAT 2 [FD 60 RT 90 FD 120 RT 90]

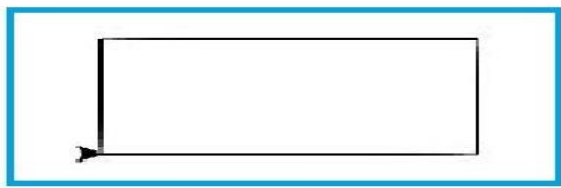

RECTANGLE

3) REPEAT 3 [FD 60 RT 120]

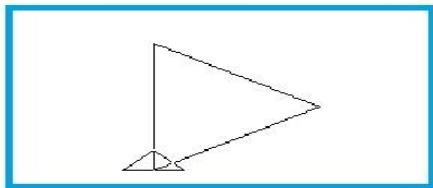

TRIANGLE

4) REPEAT 4 [FD 60 RT 72]

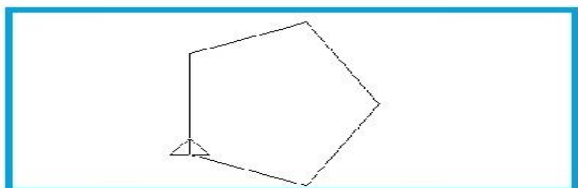

POLYGON

5) REPEAT 6 [RT 60 FD 100]

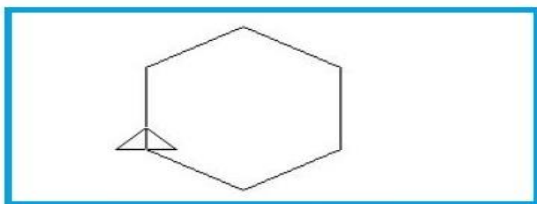

HEXAGON

6) REPEAT 360 [FD 1 RT 1]

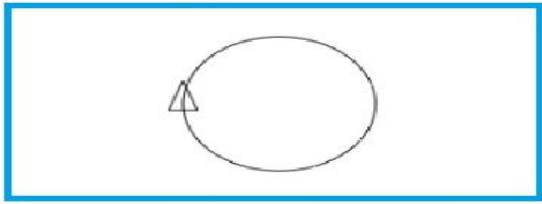

CIRCLE