



पुर्णिमा International School

Shree Swaminarayan Gurukul, Zundal

Grade-III	Subject: ENV	Ch - 5	CHHOTU'S HOUSE
-----------	--------------	--------	----------------

WORKSHEET

Q-1 Choose the correct option.

1. Animal that live inside the house.

- a) Lizard b) Cow c) Sheep

2. We cook food here.

- a) Bedroom b) Kitchen c) Livingroom

3. A house becomes home when all the _____ live together.

- a) Member b) Friend c) Teacher

4. We all need a house to _____ in.

- a) Study b) Live c) Dance

Q-2. Encircle the odd one out.

(a) Bathroom ----- Bucket, Tub, Bed, Soap

(b) Bedroom ----- Bed, Almirah, bucket, Dressing Table

(c) Drawing room ----- Sofa, table, television, sink

(d) Kitchen ----- Gas stove, shower, utensils, fridge

Q-3 Name five types of house.

Q-4 Name the part of this house and colour the pictures:-

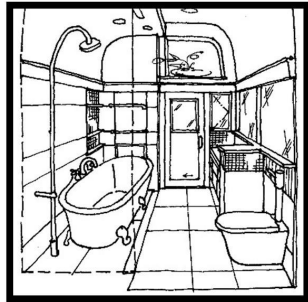

Q-4 Draw picture of uninvited animals/ insects.