

1. A **slide** is an individual page of a presentation.
2. The visual movements of slides are called **transition**.
3. On clicking the file tab, a full screen File menu appears. It is known also known as **backstage**.
4. To rotate a picture, you drag to **rotate** the handle.
5. The 'picture' option allows you to insert a picture from your computer **hard disk**
6. The main screen of **LOGO** is called Turtle's area.
- 7.The **HOME** command brings the turtle to its home position.
8. The LOGO Primitives along with **negative** [-] sign move the turtle in the opposite direction.
9. The main screen window  holds a triangle, called **turtle**.
10. The FENCE primitives creates a fence around the **screen** so that the turtle cannot go beyond the screen.

QC) State 'True' or 'False': -

- | | |
|--|---------------------|
| 1. Notes pane helps to add notes to each slide separately. | <u>TRUE</u> |
| 2. You click inside the placeholder to type in it. | <u>TRUE</u> |
| 3. To insert a new slide in a presentation, we first click the 'insert' tab | <u>FALSE</u> |
| 4. The Pictures option is available in the 'Design' tab. | <u>FALSE</u> |
| 5. Slide transition effects are present on the Transitions ribbon. | <u>TRUE</u> |
| 6. In Logo, the PD primitive converts the turtle's pen into eraser. | <u>FALSE</u> |
| 7.George Mills developed MSW LOGO. | <u>TRUE</u> |
| 8.Pointed top of the turtle is a turtle head. | <u>TRUE</u> |
| 9.The main screen of LOGO is called Turtle's Tail. | <u>FALSE</u> |
| 10.The FENCE primitive creates a fence around the screen so that the turtle cannot go beyond the screen. | <u>TRUE</u> |

QD) Write the use of following keyboard shortcuts in word and PowerPoint applications.

1. Ctrl + X **Cut**
2. Ctrl + A **Select all**
3. Ctrl + Y **Redo an undo action**
4. Ctrl + Z **Undo an action**
5. Ctrl + V **Paste**

- 6. Ctrl + N To open a new blank presentation
- 7. Ctrl + S To save a presentation
- 8. Ctrl + O To open a saved presentation
- 9. Esc To exit the slide show
- 10. F5 To run a slide show

QE) Write short form of the given commands.

- 1. HIDETURTLE HT
- 2. CLEARSCREEN CS
- 3. CLEARTEXT CT
- 4. PENDOWN PD
- 5. PENERASER PE
- 6. SHOW TURTLE ST
- 7. PENUP PU
- 8.FORWARD FD
- 9.BACK BK
- 10.RIGHT AND LEFT RT AND LT

[Section -B]

QF) Short answer questions: -

1. What is a presentation?

Ans: - A presentation is a means of communication, it provides an easy understanding of the topics.

2. What is a slide?

Ans: - A slide is a page just like a page in the notebook, in which one can add text, picture, tables, etc .

3. How do you add text to a slide?

Ans: - A dotted rectangular box that can contain title and body text or objects such as pictures, tables, charts, etc is called Placeholder.

4. How do you add text to a slide?

Ans: - To add text onto a slide, click inside a placeholder. Notice the cursor, follow it and typing your text.

5. Which ribbon provides options to insert pictures in your presentation?

Ans: - **Insert Ribbon.**

6. What is slide transition?

Ans: - **The visual movements of slides are called slide transition.**

7. Give names of any two-presentation software.

Ans:- **Microsoft PowerPoint, Open Office Impress.**

8. What is the turtle in LOGO?

Ans: - **The main screen window holds a triangle, called turtle. The turtle moves according to the LOGO commands.**

9. Write the use of the main screen?

Ans: - **The main screen of LOGO is called Turtle's area. With the help of LOGO commands we can move the turtle and draw various objects on main screen.**

10. Write the use of the Execute button.

Ans: - **Execute command button is used to execute the commands that you write in the command input box.**

11. Give primitives used to lift the turtle's pen up and to put down the pen.

Ans:- **Primitive for the turtle's pen up – PENUP or PU**
Primitive for the turtle's pen down – PENDOWN or PD

12. What is the REPEAT command?

Ans:- **The REPEAT primitive command allows us to give instruction in one line instead of giving in multiple lines.**

13. Who was the developer of MSWLOGO?

Ans:- **George Mills was developed MSWLogo.**

14. What is the full form of LOGO?

Ans:- **Language of Graphic Oriented .**

QG) Label the Microsoft PowerPoint Interface: -

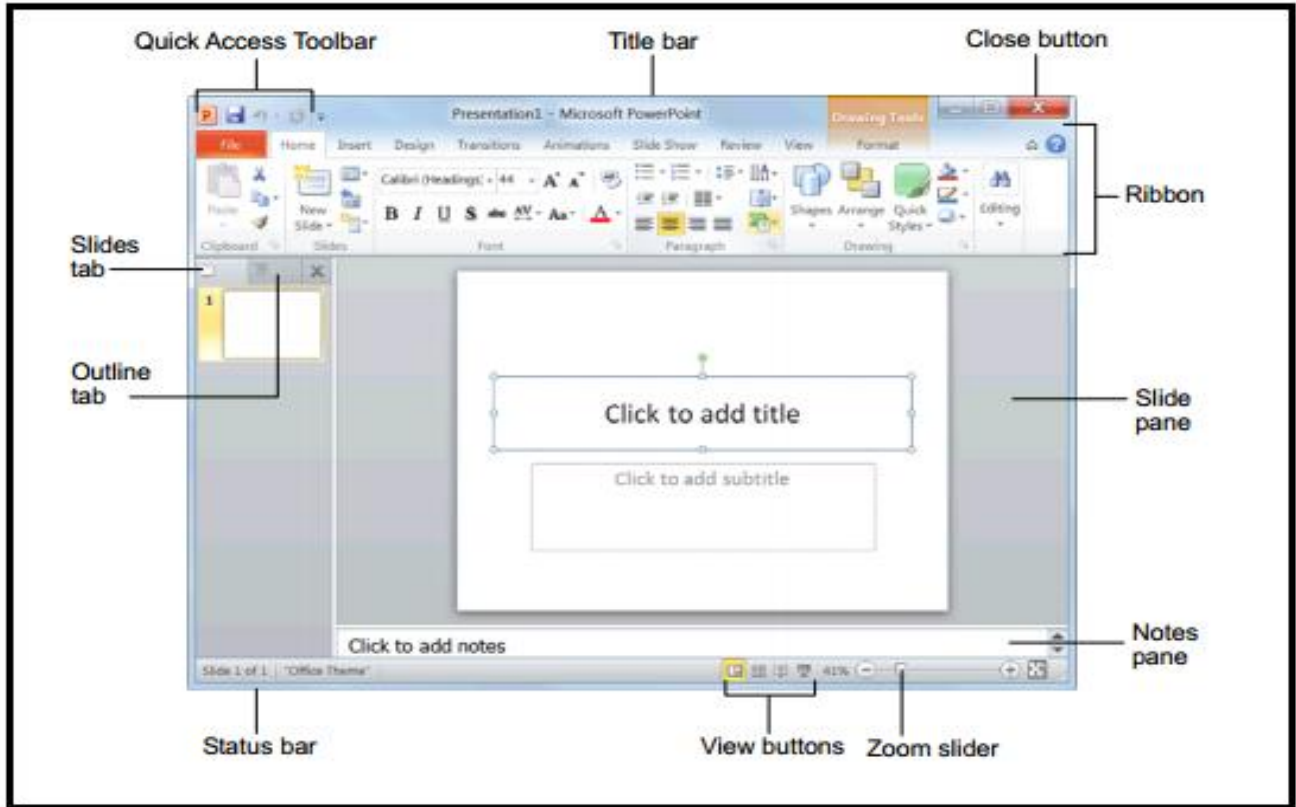

➤ Label the MSWLOGO Interface: -

